

ZVA 25 - ZVA 25 AF

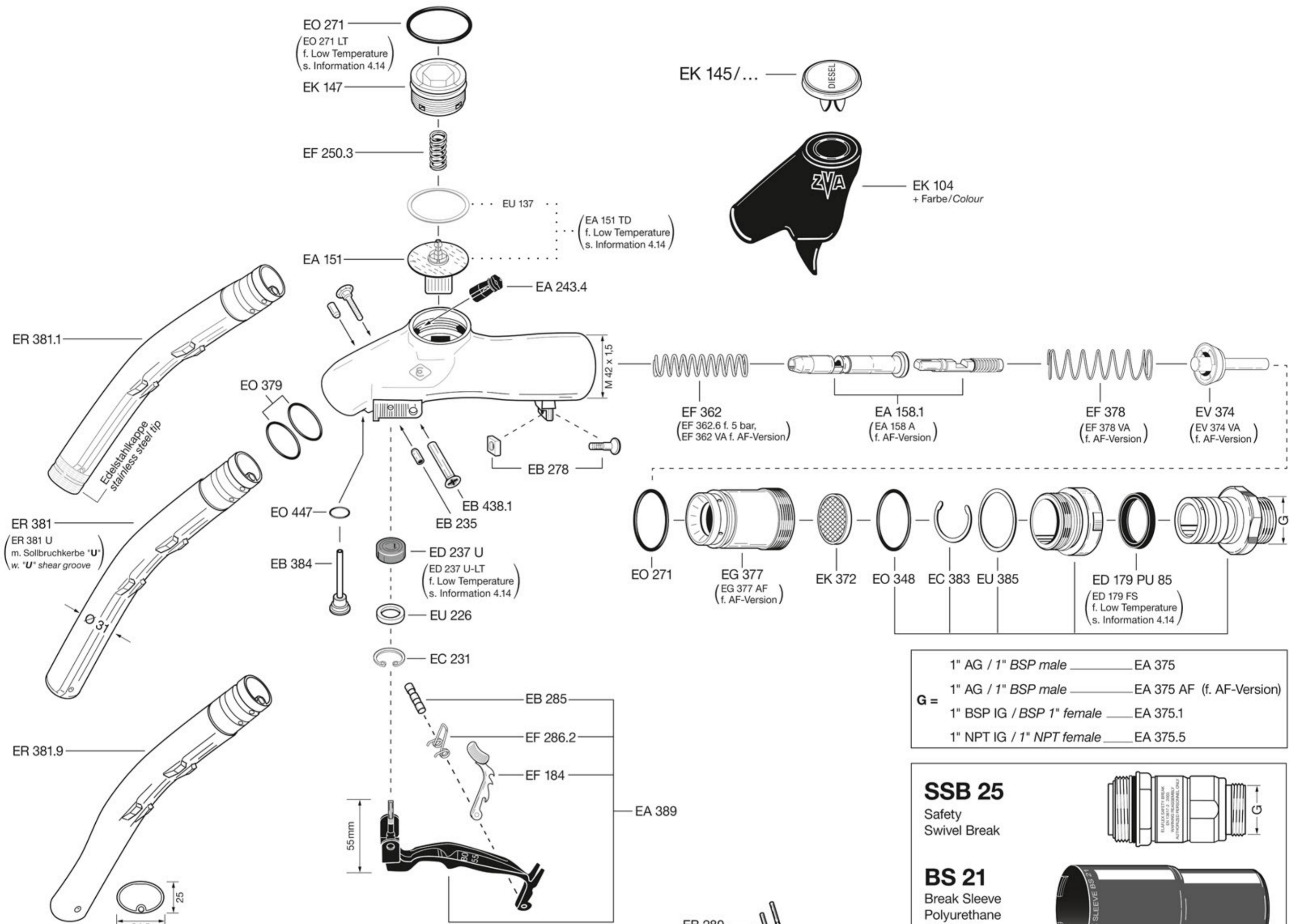

1" AG / 1" BSP male	EA 375
1" AG / 1" BSP male	EA 375 AF (f. AF-Version)
1" BSP IG / BSP 1" female	EA 375.1
1" NPT IG / 1" NPT female	EA 375.5

SSB 25
 Safety Swivel Break

BS 21
 Break Sleeve Polyurethane f. SSB 25
 + Farbe/Colour

f. ZVA 25 AF (Aircraft Refuelling)

EC 231
 EW J 1 f. EC 231
 EW J 29 f. EA 243.4
 EW 2 CV f. EB 235
 EW 5-3 f. EA 158.1
 EW 7 A
 EW 19/22 f. EK 147
 EW 27/32 f. EG 377
 EW M 36/41 f. EA 375
 EW 3 f. EA 158.1
 EW 32 Prüfadapter Flüssigkeits-/Dichtheitstest Test adapter hydraulic/tightness test
 EW 669/2 f. EB 438.1, EB 278