

Our range of quality cam locking couplings from own production are guaranteed to EN 14420-7, reliable, leak-proof, durable and offer better product properties than most Cam and Groove Couplings you will find on the market:

- Wall thickness and tolerances to standard
- Material specification to standard (stainless steel, aluminium, brass)
- Machined inner surfaces <math>< Ra 1,6</math>
- Ergonomic, contour shaped levers, optimised lever geometry for improved coupling safety
- PN 16 bar for all materials, (DN 10: 10 bar)
- Manufacturer's liability: clear Elaflex and batch marking for traceability
- Inspection test certificates EN 10204 - 3.1 available on request
- Easy attachment with standardised hook spanner

## New Quality of Cam Locking Couplings ('Camlock')

The product range is available from DN 19 to DN 100, depending on the type of material: stainless steel (also with PFA coating) brass or aluminium. Available with integrated hose tail, as threaded version or weld-on type.

### Safe, Easy ... EASYLOC®

Camlock female couplers are now also available in 'EASYLOC' version with automatic lever lock. Unwanted opening of the levers and disconnection during operation, e. g. due to excessive vibration, pulsation or accidental disengagement due to operator error is safely prevented. The operation is easy and self-explanatory. 'EASYLOC' cam locking couplers are made of stainless steel and can be ordered in the sizes from DN 19 until DN 50.

Robust lever attachment and ergonomic, contour shaped levers for improved coupling safety



 More information: [elaflex.de/en/camlock](http://elaflex.de/en/camlock)

Closing: automatic lever lock.  
Opening: pull eyelet to unlock.

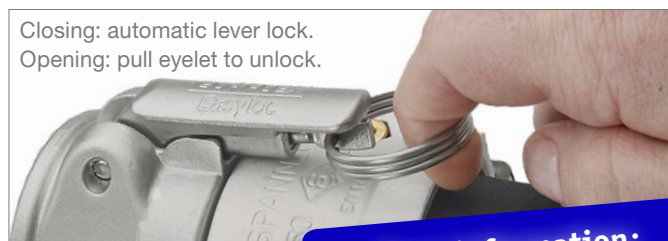

 More information: [elaflex.de/en/easyloc](http://elaflex.de/en/easyloc)

